

Valve Regulated Lead-Acid (VRLA) Battery

Specifications

Nominal Voltage		12 V
Capacity (25°C)	20HR(10.5V)	4.5Ah
	10HR(10.5V)	4.2Ah
	1HR(9.60V)	2.93Ah
Dimension	Length	90 ± 1mm (3.54inch)
	Width	70 ± 1mm (2.76inch)
	Height	101 ± 1mm (3.98inch)
	Total Height	107 ± 1mm (4.21inch)
Approx. Weight		1.46kg (3.22lbs) ± 5%
Terminal type		T1/T2
Internal resistance (Fully charged, 25°C)		Approx. 45mΩ
Capacity affected by temperature (20HR)	40°C	102%
	25°C	100%
	0°C	85%
	-15°C	65%
Self-discharge (25°C)	3 month	Remaining Capacity: 91%
	6 month	Remaining Capacity: 82%
	12 month	Remaining Capacity: 65%
Nominal operating temperature		25°C ± 3°C (77°F ± 5°F)
Operating temperature range	Discharge	-15°C ~ 50°C (5°F ~ 122°F)
	Charge	-10°C ~ 50°C (14°F ~ 122°F)
	Storage	-20°C ~ 50°C (-4°F ~ 122°F)
Float charging voltage(25°C)		13.60 to 13.80V Temperature compensation: -18mV/°C
Cyclic charging voltage(25°C)		14.50 to 14.90V Temperature compensation: -30mV/°C
Maximum charging current		1.35A
Terminal material		Copper
Maximum discharge current		67.5A(5 sec.)
Designed floating life(20°C)		5 years+

- ◆ Absorbent glass mat technology;
- ◆ Recognized by UL & CE;
- ◆ ABS container.

Constant Current Discharge Characteristics (A, 25°C)

F.V./Time	5MIN	10MIN	15MIN	30MIN	1HR	2HR	3HR	4HR	5HR	10HR	20HR
1.60V	17.75	11.58	8.54	4.94	2.86	1.69	1.22	0.98	0.82	0.45	0.23
1.65V	17.11	11.23	8.32	4.83	2.8	1.66	1.21	0.96	0.81	0.44	0.23
1.70V	16.28	10.78	8.02	4.69	2.73	1.63	1.19	0.95	0.8	0.44	0.23
1.75V	15.2	10.2	7.64	4.5	2.64	1.58	1.16	0.93	0.78	0.43	0.22
1.80V	13.85	9.45	7.15	4.26	2.52	1.53	1.12	0.9	0.76	0.42	0.22

Constant Power Discharge Characteristics (Watt, 25°C)

F.V./Time	5MIN	10MIN	15MIN	30MIN	1HR	2HR	3HR	4HR	5HR	10HR	20HR
1.60V	30.56	19.98	15.15	9.11	5.42	3.24	2.38	1.9	1.61	0.9	0.47
1.65V	30.24	19.89	15.06	9.04	5.37	3.21	2.36	1.89	1.6	0.89	0.47
1.70V	29.08	19.3	14.67	8.83	5.26	3.16	2.32	1.86	1.58	0.88	0.46
1.75V	27.65	18.59	14.17	8.56	5.1	3.09	2.28	1.82	1.55	0.87	0.45
1.80V	25.63	17.52	13.44	8.18	4.9	3	2.21	1.77	1.51	0.85	0.45

Note: The above characteristics data can be obtained within three charge/discharge cycles.

12V Voltage 4.5Ah Capacity 5years+ Design Life



ISO9001



ISO14001



Dimensions

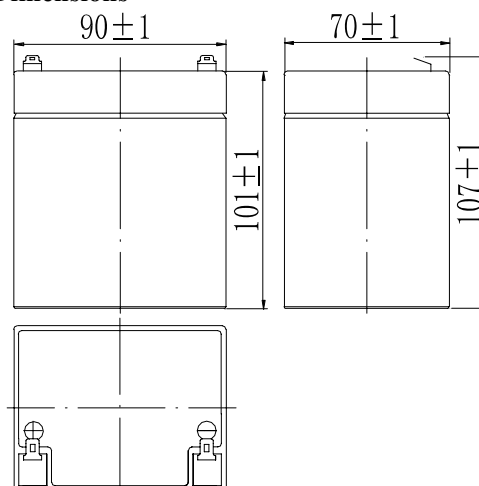

Terminal

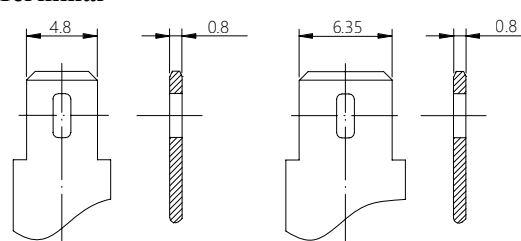

Terminal T1

Terminal T2

Applications

- All purpose
- Uninterruptable Power Supply (UPS)
- Electric Power System (EPS)
- Emergency backup power supply
- Alarm and security system
- Communication power supply
- DC power supply
- Auto control system

General Features

- 5 years design life(25°C)
- Special exhaust structure and sealing technology, safe and reliable, flexible installation, convenient maintenance
- PbCaSn alloy for plate grids: less gassing, less self-discharging
- High quality AGM separator: extend cycle life and prevent micro short circuit
- High purity raw material: ensure low self discharge rate

Standards

- Compliance with IEC 60896 standards, EU Battery Directive
- UL, CE Certified
- Manufactured in Leoch® IATF 16949, ISO 45001, ISO 9001 and ISO 14001 certified production facilities

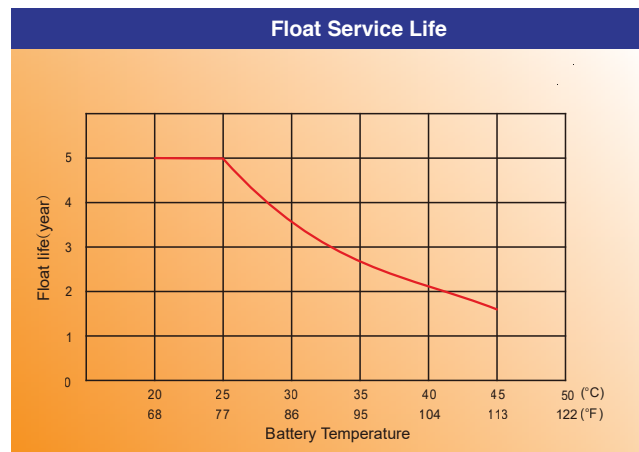
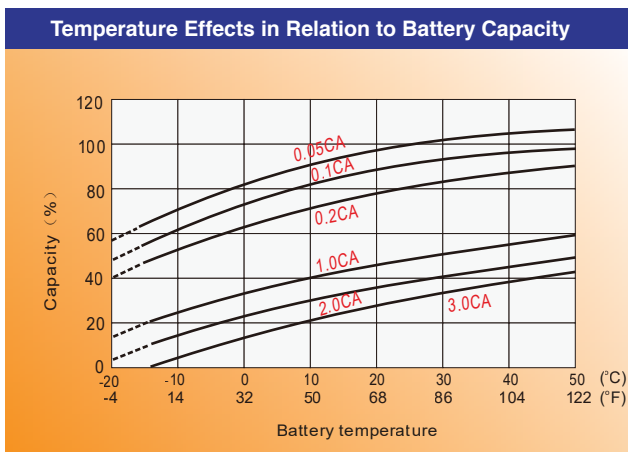
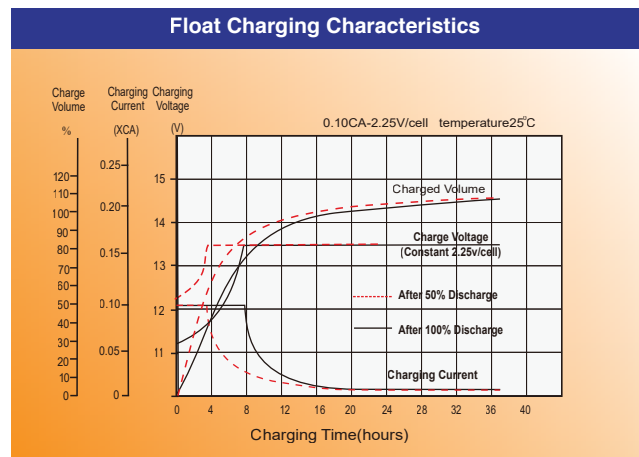
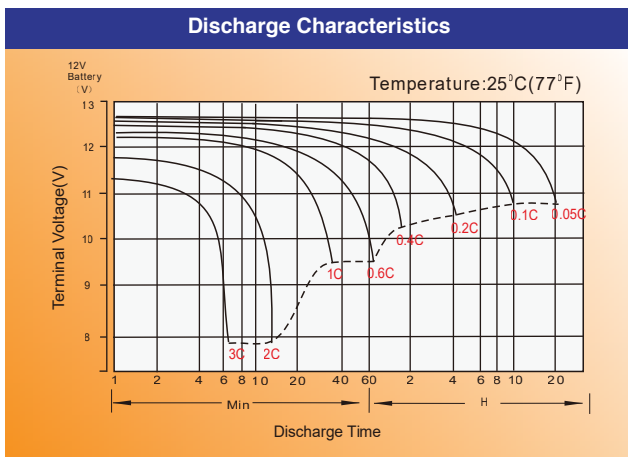

Note: Catalog images are shown for illustrative purposes only and might differ from the actual product.